



/ issue	/ date	/ reason	/ approved
E	08/22	Lot 9004 Info Added	RB

Lot 2000 DP 525252
 RT: 840111
 Owners: Ravenswood Developments Limited
 Total Area: 2973m² more or less

Lot 1 DP 72463
 RT: CB41D/1228
 Owners: Ravenswood Developments Limited
 Total Area: 1.0717ha more or less

Lot 9004 DP 569585
 RT: 1027175
 Owners: Ravenswood Developments Limited
 Total Area: 23.1317ha more or less

Areas and dimensions are subject to final survey.
 A full assessment of easements will be undertaken upon completion of the survey. This may result in additional easements to those already shown

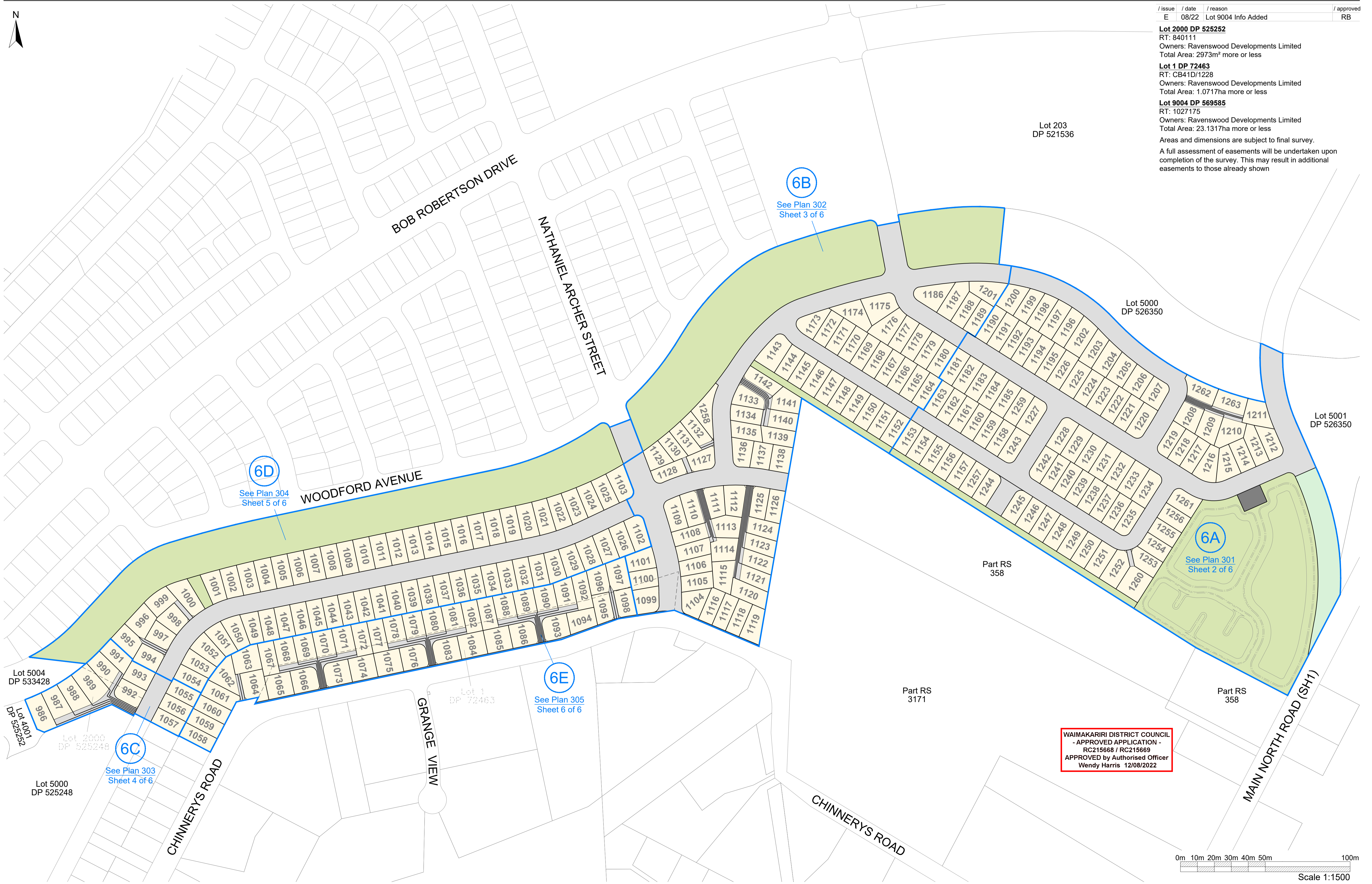

WAIMAKARIRI DISTRICT COUNCIL
 - APPROVED APPLICATION -
 RC215668 / RC215669
 APPROVED by Authorised Officer
 Wendy Harris 12/08/2022

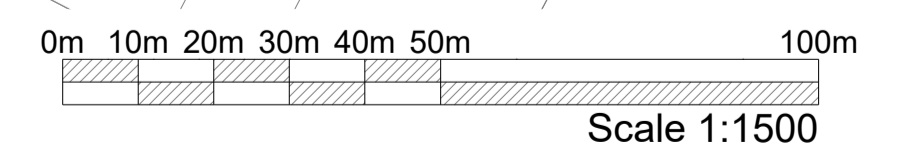

/ issue	/ date	/ reason	/ approved
E	08/22	Lot 9004 Info Added	RB

MEMORANDUM OF EASEMENTS			
NATURE	BURDENED LAND LOT NO	BENEFITED LAND/GRANTEE	SHOWN
RIGHT OF WAY	1252	BX	1260
	1253	BY	1260
	1260	CG	1253
RIGHT OF WAY, RIGHT TO DRAIN SEWAGE & WATER, RIGHT TO CONVEY WATER, ELECTRICITY, TELECOMMUNICATIONS & COMPUTER MEDIA	1208	BZ	1209-1211, 1262, 1263
	1209	CA	1208, 1210, 1211
	1210	CB	1208, 1209, 1211
	1211	CD	1208-1210, 1262, 1263
	1262	CE	1208-1211, 1263
	1263	CF	1208-1211, 1262



WAIMAKARIRI DISTRICT COUNCIL
- APPROVED APPLICATION -
RC215668 / RC215669
APPROVED by Authorised Officer
Wendy Harris 12/08/2022

MEMORANDUM OF EASEMENTS		
NATURE	BURDENED LAND LOT NO	BENEFITED LAND/GRANTEE
RIGHT OF WAY, RIGHT TO DRAIN SEWAGE & WATER, RIGHT TO CONVEY WATER, ELECTRICITY, TELECOMMUNICATIONS & COMPUTER MEDIA	1107	AE 1108, 1110, 1111, 1113, 1114
	1108	AF 1107, 1110, 1111, 1113, 1114
	1110	AG 1107, 1108, 1111, 1113, 1114
	1111	AH 1107, 1108, 1110, 1113, 1114
	1113	AI 1107, 1108, 1110, 1111, 1114
	1114	AJ 1107, 1108, 1110, 1111, 1113
	1115	AK 1120-1124
	1120	AL 1115, 1121-1124
	1121	AM 1115, 1120, 1122-1124
	1122	AN 1115, 1120, 1121, 1123, 1124
	1123	AO 1115, 1120-1122, 1124
	1124	AP 1115, 1120-1123
	1131	AQ 1132
	1132	AR 1131
	1133	AS 1139-1142
	1139	AT 1133, 1140-1142
	1140	AU 1133, 1139, 1141, 1142
1141	AV 1133, 1139, 1140, 1142	
1142	AW 1133, 1139-1141	

MEMORANDUM OF EASEMENTS		
NATURE	BURDENED LAND LOT NO	BENEFITED LAND/GRANTEE
RIGHT OF WAY	1110	BM 1107, 1108, 1111, 1113, 1114
	1111	BN 1107, 1108, 1110, 1113, 1114
	1112	BO 1115, 1120-1124
	1125	BP 1130
	1127	BQ 1131, 1132
	1128	BR 1130
	1132	BT 1131
	1258	BU 1131, 1132
	1133	BV 1139-1142
	1142	BW 1133, 1139-1141
	1130	CG 1127

/ issue	/ date	/ reason	/ approved
E	08/22	Lot 9004 Info Added	RB

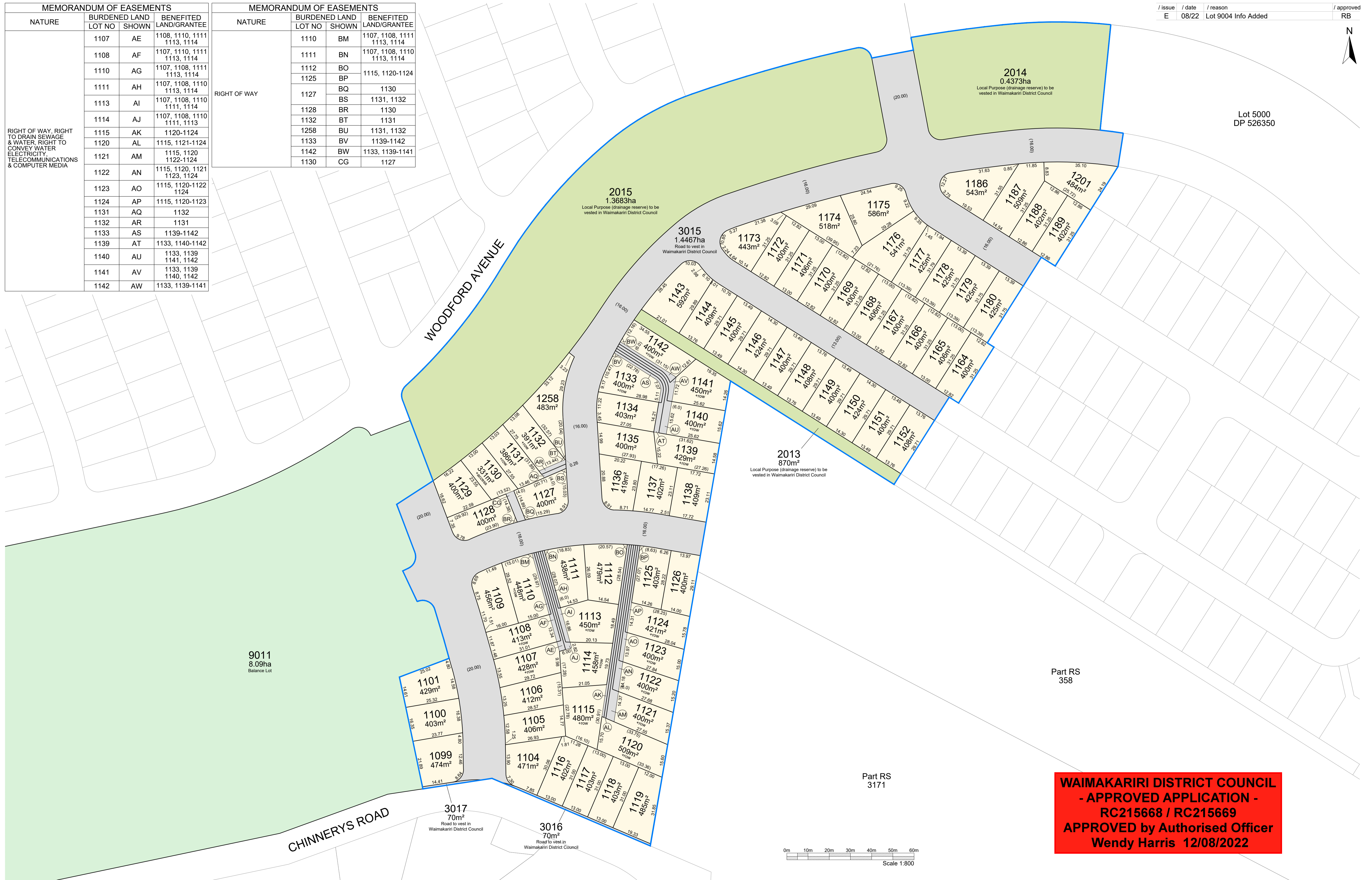

WAIMAKARIRI DISTRICT COUNCIL
- APPROVED APPLICATION -
RC215668 / RC215669
APPROVED by Authorised Officer
Wendy Harris 12/08/2022

MEMORANDUM OF EASEMENTS			
NATURE	BURDENED LAND LOT NO	SHOWN	BENEFITED LAND/GRANTEE
RIGHT OF WAY, RIGHT TO DRAIN SEWAGE & WATER, RIGHT TO CONVEY WATER, ELECTRICITY, TELECOMMUNICATIONS & COMPUTER MEDIA	986	A	987-991
	987	B	986, 988-991
	988	C	986, 987, 989-991
	989	D	986-988, 990, 991
	990	E	986-989, 991
	991	F	986-990
RIGHT OF WAY	992	AX	986-991

/ issue	/ date	/ reason	/ approved
E	08/22	Lot 9004 Info Added	RB

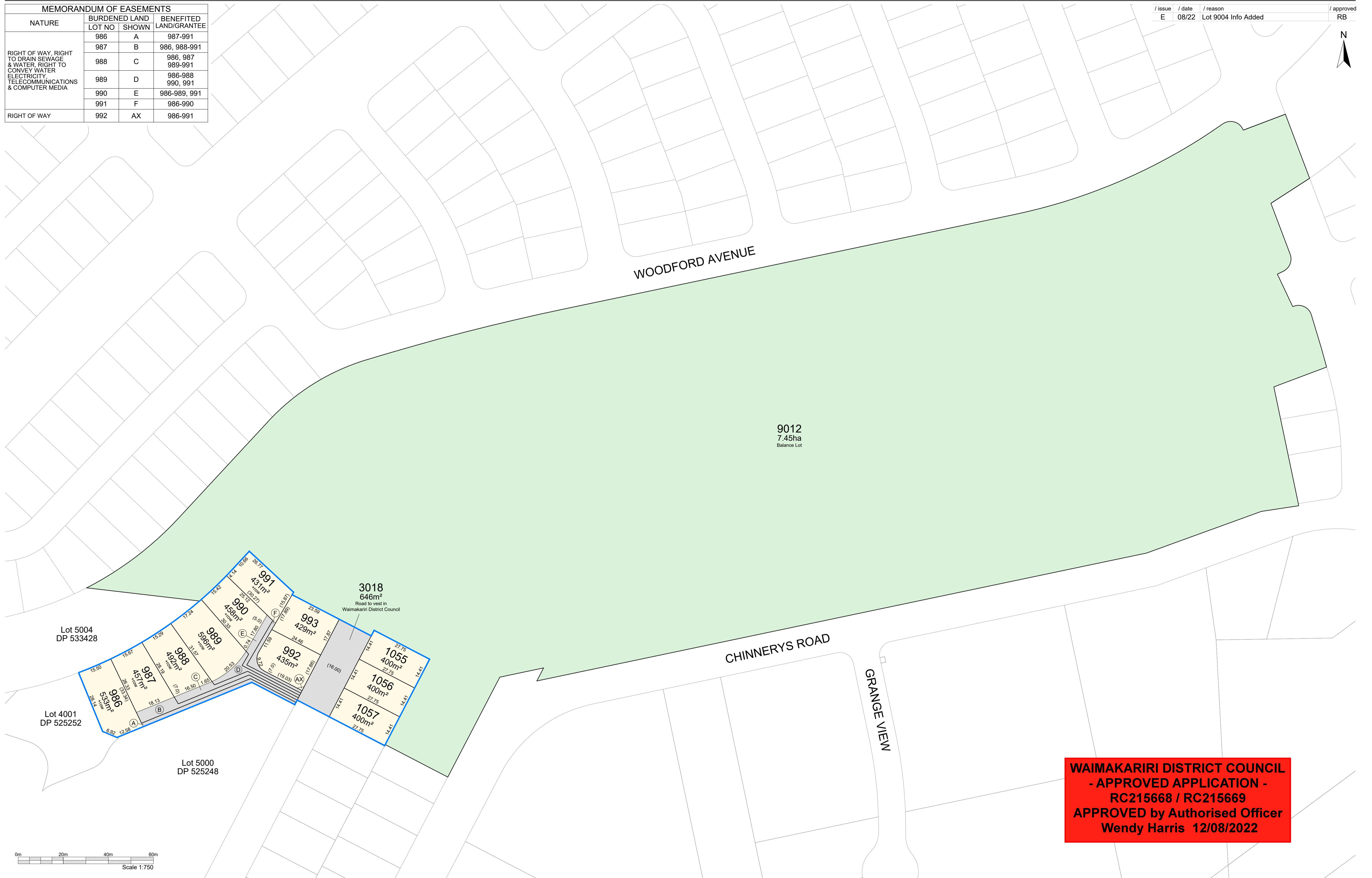

WAIMAKARIRI DISTRICT COUNCIL
- APPROVED APPLICATION -
RC215668 / RC215669
APPROVED by Authorised Officer
Wendy Harris 12/08/2022

MEMORANDUM OF EASEMENTS			
NATURE	BURDENED LAND LOT NO	SHOWN	BENEFITED LAND/GRANTEE
RIGHT OF WAY, RIGHT TO DRAIN SEWAGE & WATER, RIGHT TO CONVEY WATER, ELECTRICITY, TELECOMMUNICATIONS & COMPUTER MEDIA	995	AM	996
	996	AN	995
	999	BM	1000
	994	AY	995, 996
RIGHT OF WAY	997	AZ	995, 996
	998	BA	999, 1000
	1000	BB	999

/ issue	/ date	/ reason	/ approved
E	08/22	Lot 9004 Info Added	RB



WAIMAKARIRI DISTRICT COUNCIL
- APPROVED APPLICATION -
RC215668 / RC215669
APPROVED by Authorised Officer
Wendy Harris 12/08/2022







MEMORANDUM OF EASEMENTS		
NATURE	BURDENED LAND LOT NO	BENEFITED LAND/GRANTEE
RIGHT OF WAY, RIGHT TO DRAIN SEWAGE & WATER, RIGHT TO CONVEY WATER, ELECTRICITY, TELECOMMUNICATIONS & COMPUTER MEDIA	1062	I 1063
	1063	J 1062
	1067	K 1068-1072
	1068	L 1067, 1069-1072
	1069	M 1067, 1068, 1070-1072
	1070	N 1067-1069, 1071, 1072
	1071	O 1067-1070, 1072
	1072	P 1067-1071
	1077	Q 1078-1082
	1078	R 1077, 1079-1082
	1079	S 1077, 1078, 1080-1082
	1080	T 1077-1079, 1081, 1082
	1081	U 1077-1080, 1082
	1082	V 1077-1081
	1087	W 1088-1092
	1088	X 1087, 1089-1092
	1089	Y 1087, 1088, 1090-1092
	1090	Z 1087-1089, 1091, 1092
	1091	AA 1087-1090, 1092
	1092	AB 1087-1091
1096	AC 1097	
1097	AD 1096	
RIGHT OF WAY	1061	BC 1062, 1063
	1064	BD 1062, 1063
	1066	BE 1067-1072
	1073	BF 1067-1072
	1076	BG 1077-1082
	1083	BH 1077-1082
	1086	BI 1087-1092
	1093	BJ 1087-1092
	1095	BK 1096, 1097
	1098	BL 1096, 1097

/ issue	/ date	/ reason	/ approved
E	08/22	Lot 9004 Info Added	RB

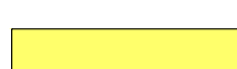

WAIMAKARIRI DISTRICT COUNCIL
- APPROVED APPLICATION -
RC215668 / RC215669
APPROVED by Authorised Officer
Wendy Harris 12/08/2022

LEGEND:

-  Stage Boundary
-  NZTA Woodend Bypass Designation
-  Collector Road - Type A
-  Collector Road - Type B
-  Local Road (Primary)
-  Local Road (Secondary)
-  Chinnery's Road (Primary)

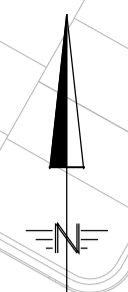

Rev.	Date	Reason	Approved
A1	11/11/21	Issued for Information	DB/JA
A2	15/12/21	Issued for Information	JA

FOR APPROVAL

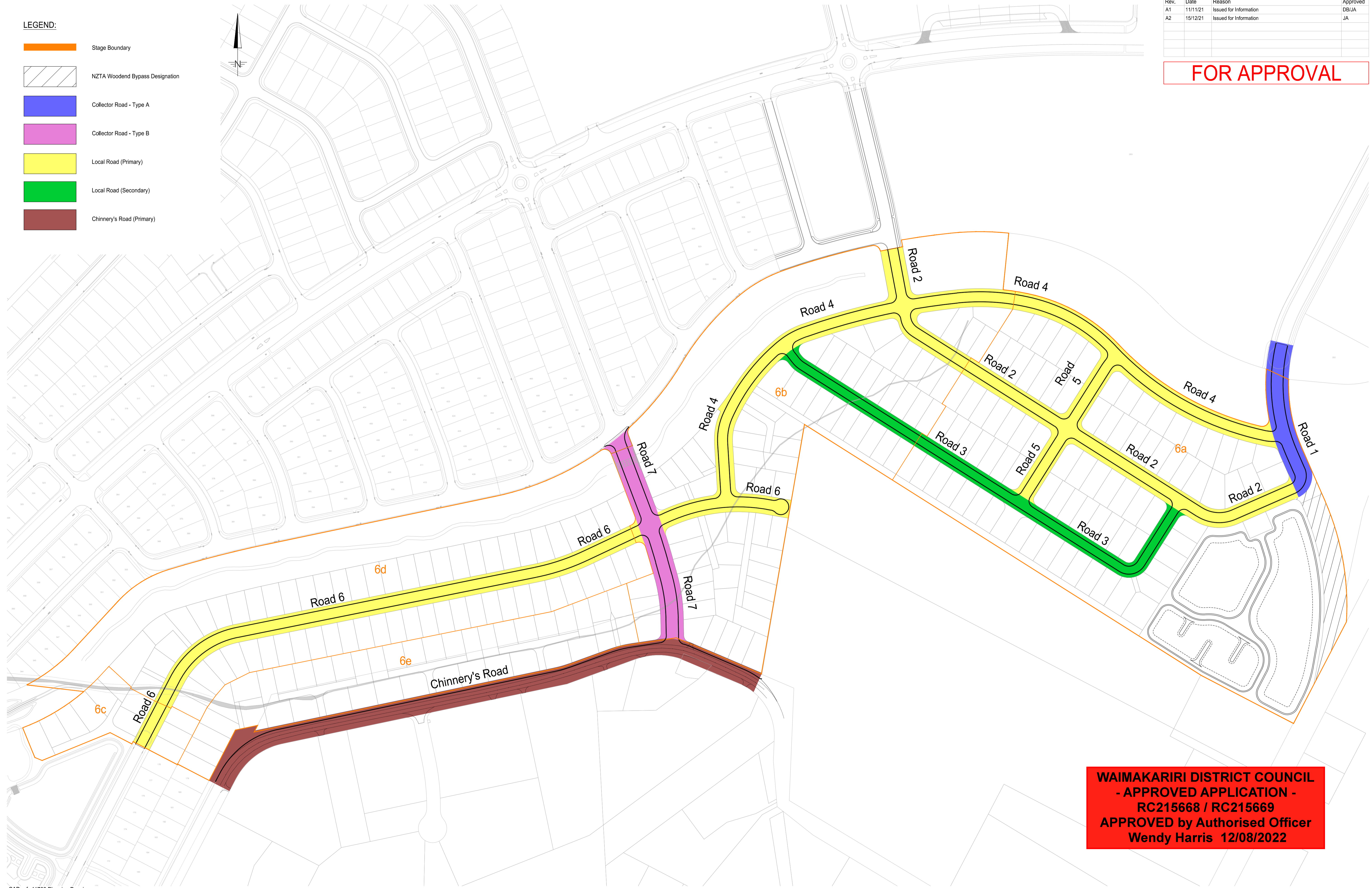

WAIMAKARIRI DISTRICT COUNCIL
 - APPROVED APPLICATION -
 RC215668 / RC215669
 APPROVED by Authorised Officer
 Wendy Harris 12/08/2022