

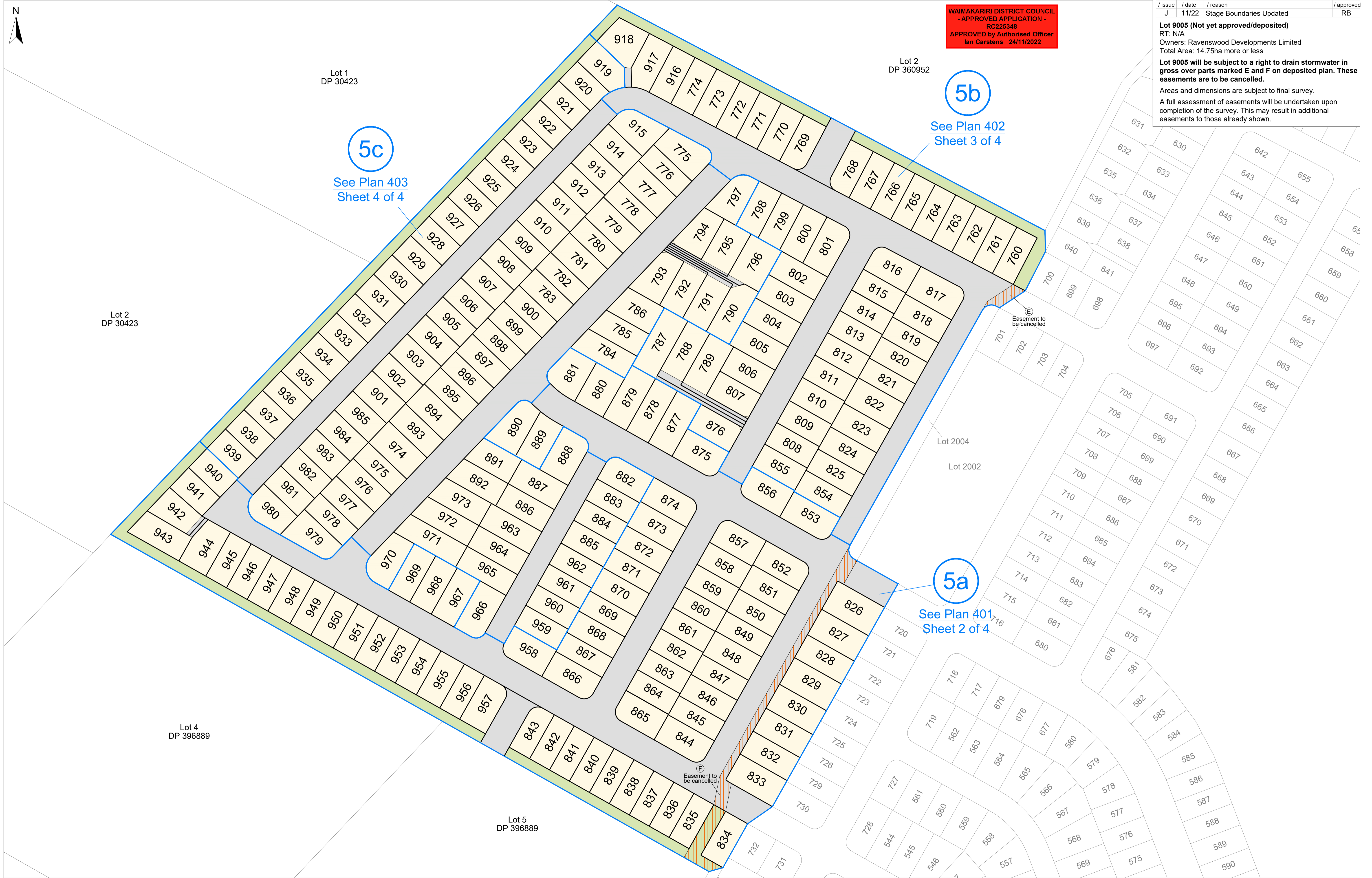

WAIMAKARIRI DISTRICT COUNCIL
- APPROVED APPLICATION -
RC225348
APPROVED by Authorised Officer
Ian Carstens 24/11/2022

/ issue	/ date	/ reason	/ approved
J	11/22	Stage Boundaries Updated	RB

Lot 9005 (Not yet approved/deposited)
 RT: N/A
 Owners: Ravenswood Developments Limited
 Total Area: 14.75ha more or less
Lot 9005 will be subject to a right to drain stormwater in gross over parts marked E and F on deposited plan. These easements are to be cancelled.
 Areas and dimensions are subject to final survey.
 A full assessment of easements will be undertaken upon completion of the survey. This may result in additional easements to those already shown.





MEMORANDUM OF EASEMENTS			
NATURE	BURDENED LAND LOT NO	SHOWN	BENEFITED LAND/GRANTEE
RIGHT OF WAY, RIGHT TO DRAIN SEWAGE & WATER, RIGHT TO CONVEY WATER ELECTRICITY TELECOMMUNICATIONS & COMPUTER MEDIA	942	M	Lot 943
	943	N	Lot 942

WAIMAKARIRI DISTRICT COUNCIL
 - APPROVED APPLICATION -
 RC225348
 APPROVED by Authorised Officer
 Ian Carstens 24/11/2022





/ issue	/ date	/ reason	/ approved
J	11/22	Stage Boundaries Updated	RB

MEMORANDUM OF EASEMENTS			
NATURE	BURDENED LAND LOT NO	SHOWN	BENEFITED LAND/GRANTEE
RIGHT OF WAY, RIGHT TO DRAIN SEWAGE & WATER, RIGHT TO CONVEY WATER ELECTRICITY TELECOMMUNICATIONS & COMPUTER MEDIA	787	A	Lots 788, 789
	788	B	Lots 787, 789
	789	C	Lots 787, 788
RIGHT OF WAY	807	K	Lots 787-789
	876	L	Lots 787-789

WAIMAKARIRI DISTRICT COUNCIL
 - APPROVED APPLICATION -
 RC225348
 APPROVED by Authorised Officer
 Ian Carstens 24/11/2022





WAIMAKARIRI DISTRICT COUNCIL
 - APPROVED APPLICATION -
 RC225348
 APPROVED by Authorised Officer
 Ian Carstens 24/11/2022

/ issue	/ date	/ reason	/ approved
J	11/22	Stage Boundaries Updated	RB

MEMORANDUM OF EASEMENTS			
NATURE	BURDENED LAND LOT NO	BENEFITED LAND SHOWN	BENEFITED LAND/GRANTEE
RIGHT OF WAY, RIGHT TO DRAIN SEWAGE & WATER, RIGHT TO CONVEY WATER, ELECTRICITY, TELECOMMUNICATIONS & COMPUTER MEDIA	790	D	Lots 791, 792, 795, 796
	791	E	Lots 790, 792, 795, 796
	792	F	Lots 790, 791, 795, 796
	795	G	Lots 790-792, 796
	796	H	Lots 790-792, 795
RIGHT OF WAY	793	I	Lots 790-792, 795
	794	J	Lots 790-792, 795, 796

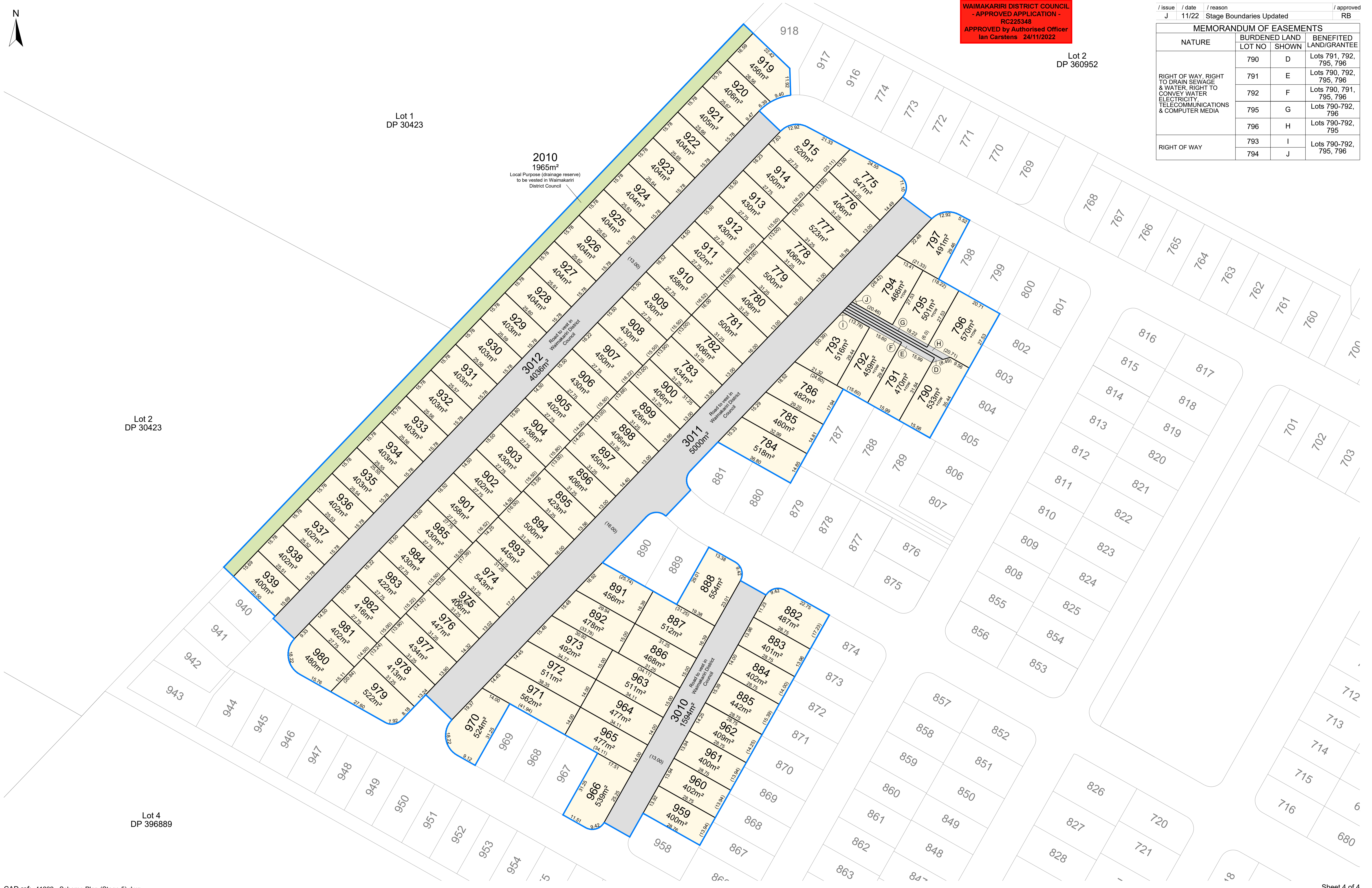

do DAVIS OGILVIE
 ENGINEERS / SURVEYORS / PLANNERS

Davis Ogilvie & Partners Limited
 Level 1, 24 Moorhouse Avenue, Addington, Christchurch 8140
 Office 0800 999 333 Email hello@do.nz
 www.do.nz

**Proposed Subdivision of Lot 9005
 Ravenswood Stage 5c**

RAVENSWOOD
 NORTH CANTERBURY

/ design	/ drawn	/ QA check	/ dwg
RB/BL	BL	RB	403
/ scale @A1	/ date	/ file	/ issue
1:750	03/21	41262	J